

TYPICAL MODEL H-80 - H-200

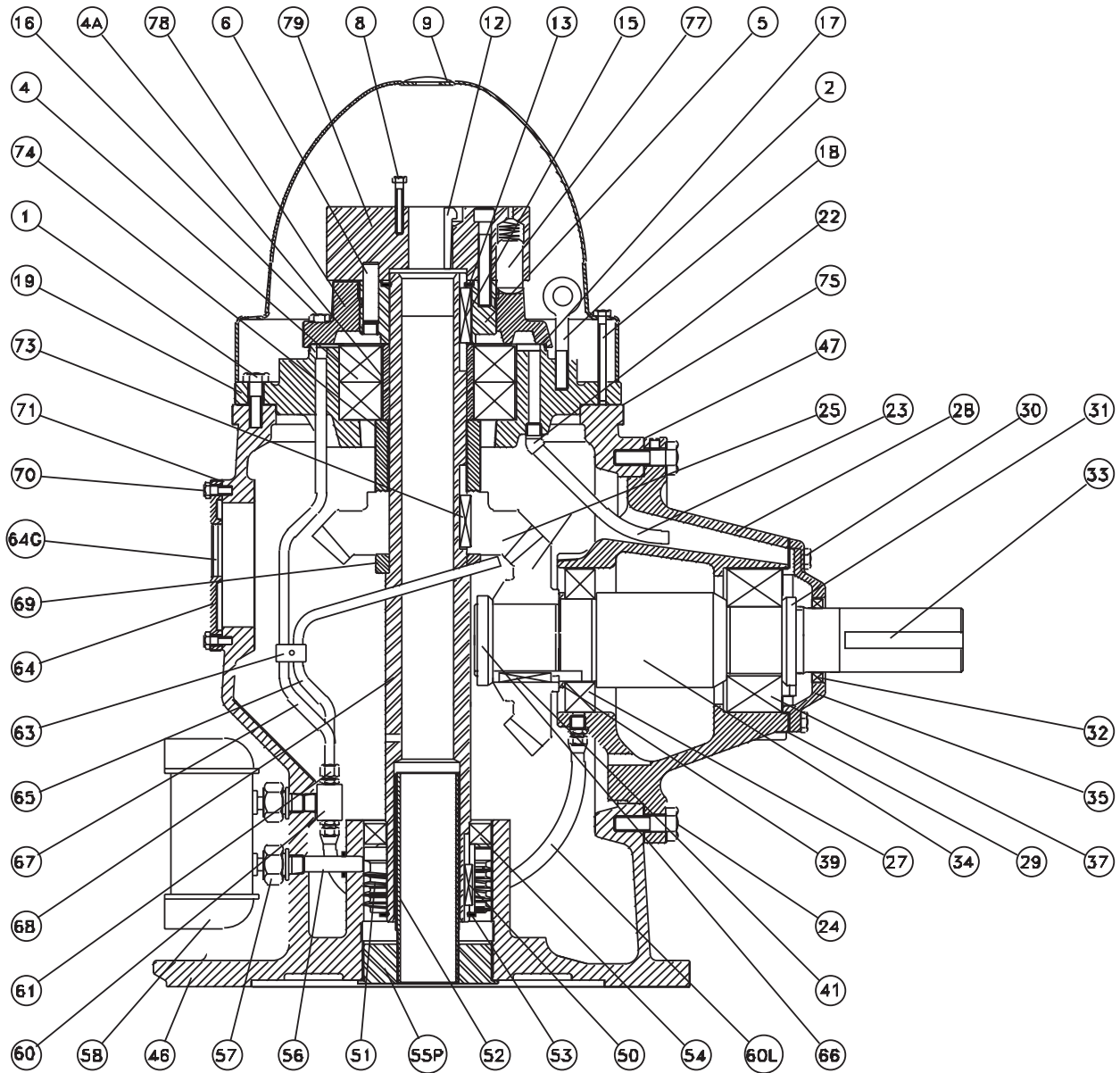

No.	Part Name	No.	Part Name	No.	Part Name	No.	Part Name
1	Capscrew-Thrust Cage	*23	Flexible Tube	46	Main Housing	64	Inspection Plate
*2	Lifting Eyebolt	24	Capscrew-Horiz. Housing	47	Shim-Horz. Housing	*64G	Oil Sight Glass
4	Thrust Bearing	25	Gears	50	Key-Pump Runner	65	Oil Tube To Gears
*4A	Thrust Bearing Sleeve	27	Inner Bearing	51	Pump Runner	*66	Locknut & Washer
5	Lower Coupling	28	Horizontal Housing	52	Seal Tube	67	Oil Tube to Thrust Brg.
6	Coupling Pin	29	Gasket-Horz. Hsg. Cover	53	External Snap Ring	68	Hollow Shaft
8	Capscrew	30	Capscrew-Horz. Hsg. Cover	54	Pump Bearing	*69	Vertical U.G. Spacer
9	Dome			55P	Seal Plug	70	Capscrew-Insp. Plate
12	Gib Key	*31	Locknut & Washer	56	Oil Tube From Pump	71	Gasket-Insp. Plate
13	External Snap Ring	32	Oil Seal	57	Cooler Flexible Fittings	73	Key-Driven Gear
15	Key-Lower Coupling	33	Key	58	Oil Cooler	74	Vertical M.D. Spacer
16	Capscrew-Thrust Cover	34	Drive Shaft	60	Oil Distributor	75	Shim-Thrust Brg. Cage
17	Gasket-Thrust Cover	35	Horizontal Housing Cover	60L	Oil Tube To Inner Bearing	77	Ratchet Pins
18	Capscrew-Dome	37	Outer Bearing	61	Compression Fitting	78	Thrust Bearing Cover
19	Thrust Bearing Cage	39	Horizontal M.D. Spacer	63	Oil Tube Clamp	79	Upper Clutch
*22	Flexible Tube Fitting	41	Key-Drive Gear				

* These parts are not universal and are omitted in certain ratios and models.