

TYPICAL SPRAG NON-REVERSE

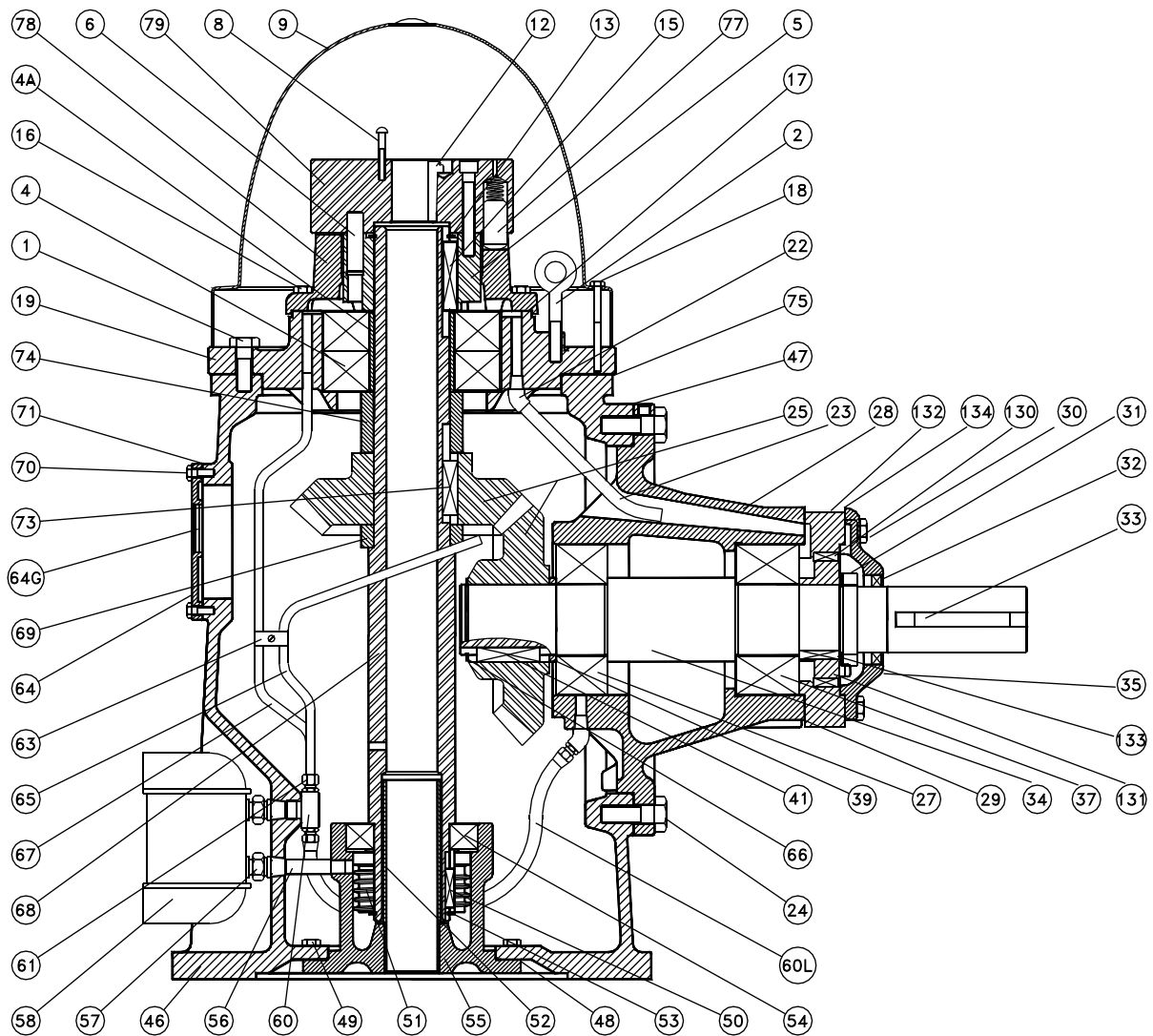

No.	Part Name	No.	Part Name	No.	Part Name	No.	Part Name
1	Capscrew-Thrust Cage	25	Gears	50	Key-Pump Runner	*69	Vertical U.G. Spacer
2	Lifting Eyebolt	27	Inner Bearing	51	Pump Runner	70	Capscrew-Insp. Plate
4	Thrust Bearing	28	Horizontal Housing	52	Seal Tube	71	Gasket-Insp. Plate
*4A	Thrust Bearing Sleeve	29	Gasket-Horz. Hsg. Cover	53	External Snap Ring	73	Key-Driven Gear
5	Lower Coupling	30	Capscrew-Horz. Hsg. Cover	54	Pump Bearing	74	Vertical M.D. Spacer
6	Coupling Pin	*31	Locknut & Washer	55	Pump Housing	75	Shim-Thrust Brg. Cage
8	Capscrew	32	Oil Seal	56	Oil Tube From Pump	77	Ratchet Pins
9	Dome	33	Key	57	Cooler Flexible Fittings	78	Thrust Bearing Cover
12	Gib Key	34	Drive Shaft	58	Oil Cooler	79	Upper Clutch
13	External Snap Ring	35	Horizontal Hsg. Cover	60	Oil Distributor	74	Vertical M.D. Spacer
15	Key-Lower Coupling	37	Outer Bearing	60L	Oil Tube To Inner Bearing	75	Shim-Thrust Brg. Cage
16	Capscrew-Thrust Cover	39	Horizontal M.D. Spacer	61	Compression Fitting	77	Ratchet Pins
17	Gasket-Thrust Cover	41	Key-Drive Gear	63	Oil Tube Clamp	78	Thrust Bearing Cover
18	Capscrew-Dome	46	Main Housing	64	Inspection Plate	79	Upper Clutch
19	Thrust Bearing Cage	47	Shim-Horz. Housing	*64G	Oil Sight Glass	130	Sprag Clutch
*22	Flexible Tube Fitting	48	Gasket-Pump Housing	65	Oil Tube To Gears	131	Inner Race
*23	Flexible Tube	49	Capscrew-Pump Housing	*66	External Snap Ring	132	Outer Race
24	Capscrew-Horz.Hsg.			67	Oil Tube to Thrust Brg.	133	Key
				68	Hollow Shaft	134	Gasket-Horz Hsg. Cover

* These parts are not universal and are omitted in certain ratios and models.